

all-in-one

Sharpening Platform

Sharpening with sandpaper is quick, inexpensive, and the results can't be beat.

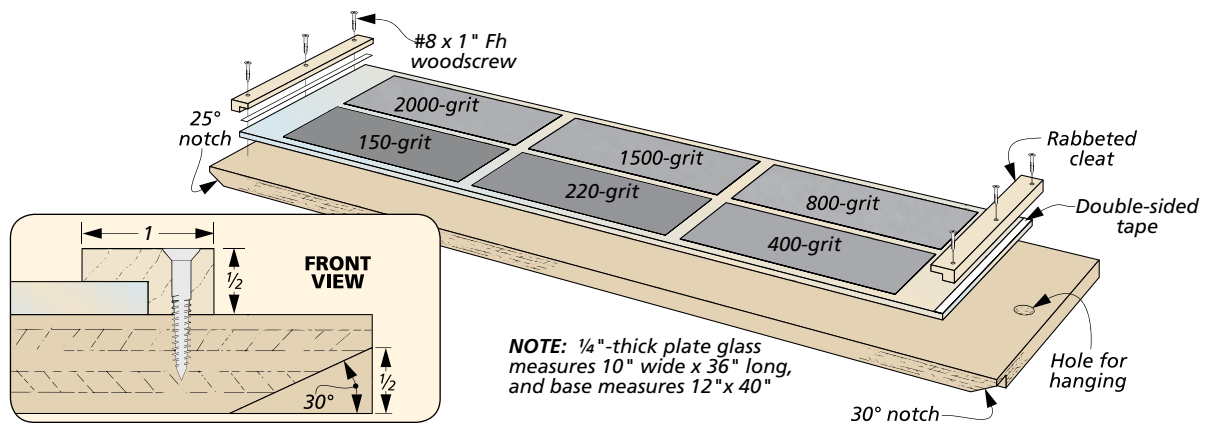

Here's how to put a sharpening platform together. First, ask a glass supplier to cut a piece 1/4"-thick plate glass and soften the edges for you. Next, use rabbeted cleats to fasten the glass to a 3/4" plywood base. This makes the glass easier to manage. (I also put a piece of double-sided tape on the ends of the glass to prevent it from shifting.) A couple of angled notches in the corners of the base act as set-up guides for sharpening. And finally, a hole in the end for hanging makes storage easy.

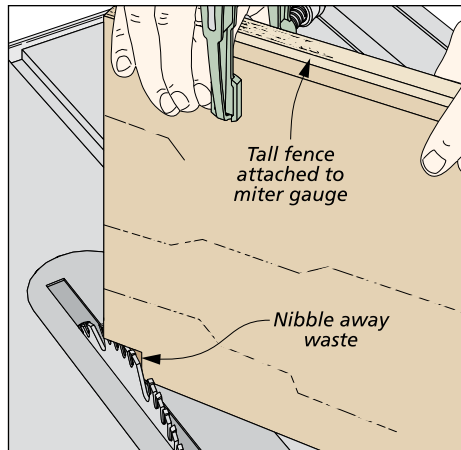

Nibble Away Waste. A tall fence attached to the miter gauge allows you to cut the "guide" notches in the plywood base. A hand saw could also be used to do the job.