

# Online Extra

# Console Case

# Dado Jig

Every router base is slightly different in size so it's best to build the jig to fit your router. Start with laying out the location of one of the dados on the bottom and divider. Remember, your layout is the size of the bushing ( $\frac{5}{8}$ " in this case) not the actual dado. Then follow the steps below. Start with the larger case bottom, then use spacers on the jig for the dividers.

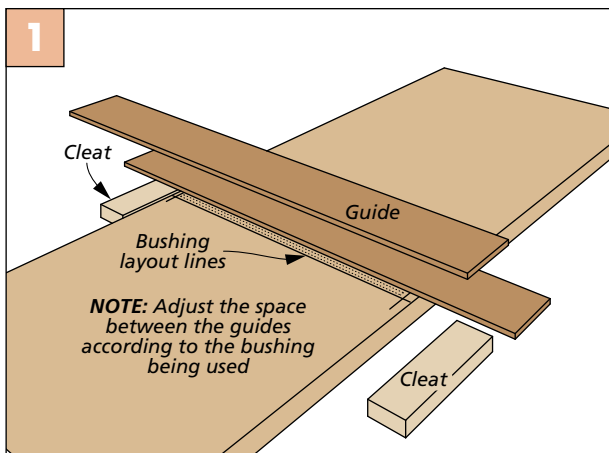
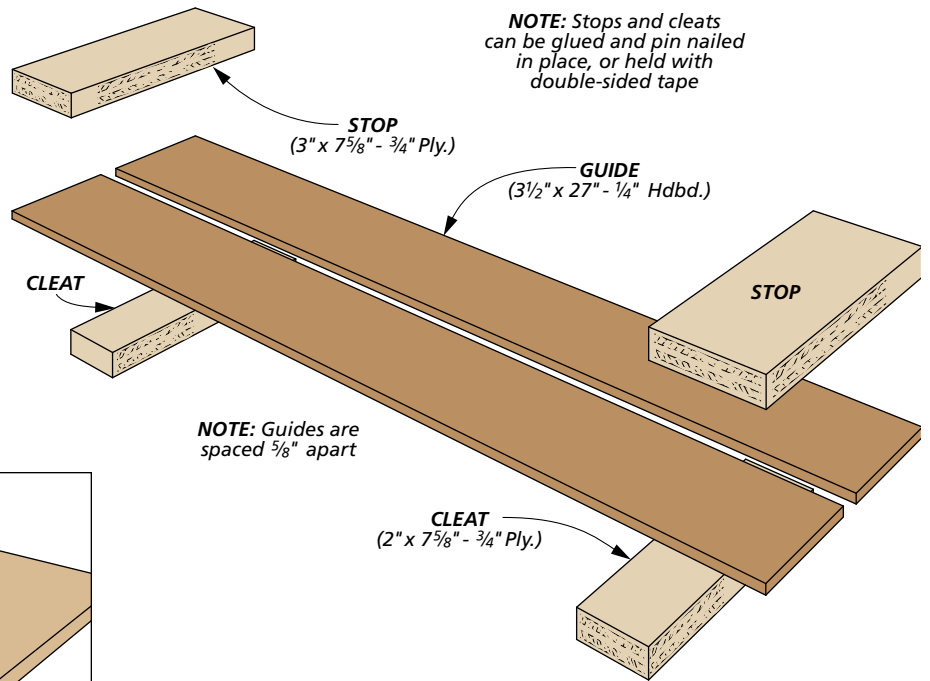

**Cleats Come First.** After drawing the location of the dado on the workpiece align the guides to the lines. Glue and pin nail the cleats to the underside of the guides.

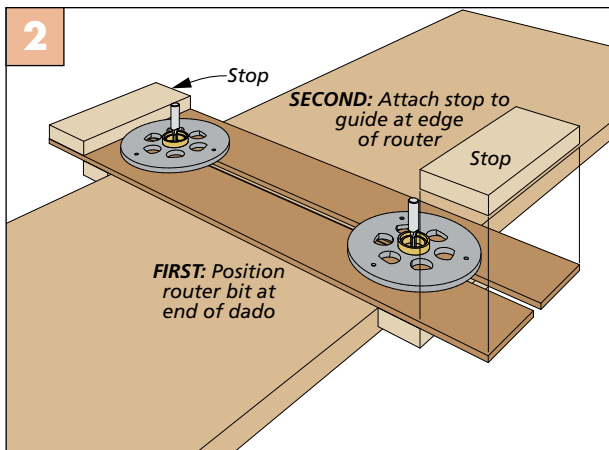

**Set the Stops.** With the router bit retracted, establish the stopping points at the ends of the dado. Use glue and pin nails (or double-sided tape) to hold the stops in place.

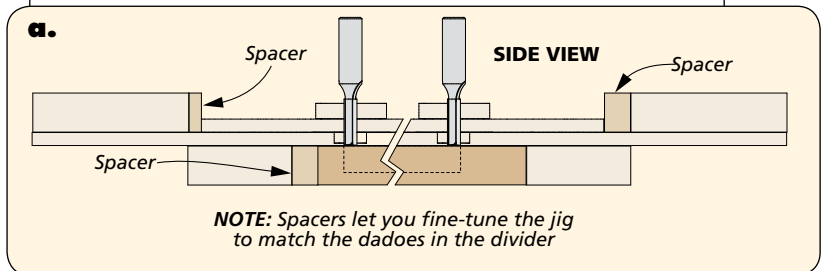
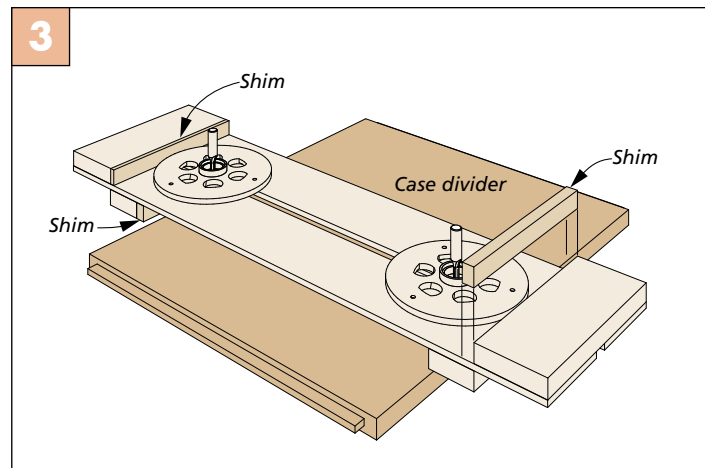

**Adjust the Jig.** The dados in the dividers are the same width and depth as the ones in the bottom, just shorter. Start by adding a spacer to the cleat, then add the two spacers to the stops to set the length and position of the dado.