

Deep Reach Clamp Patterns

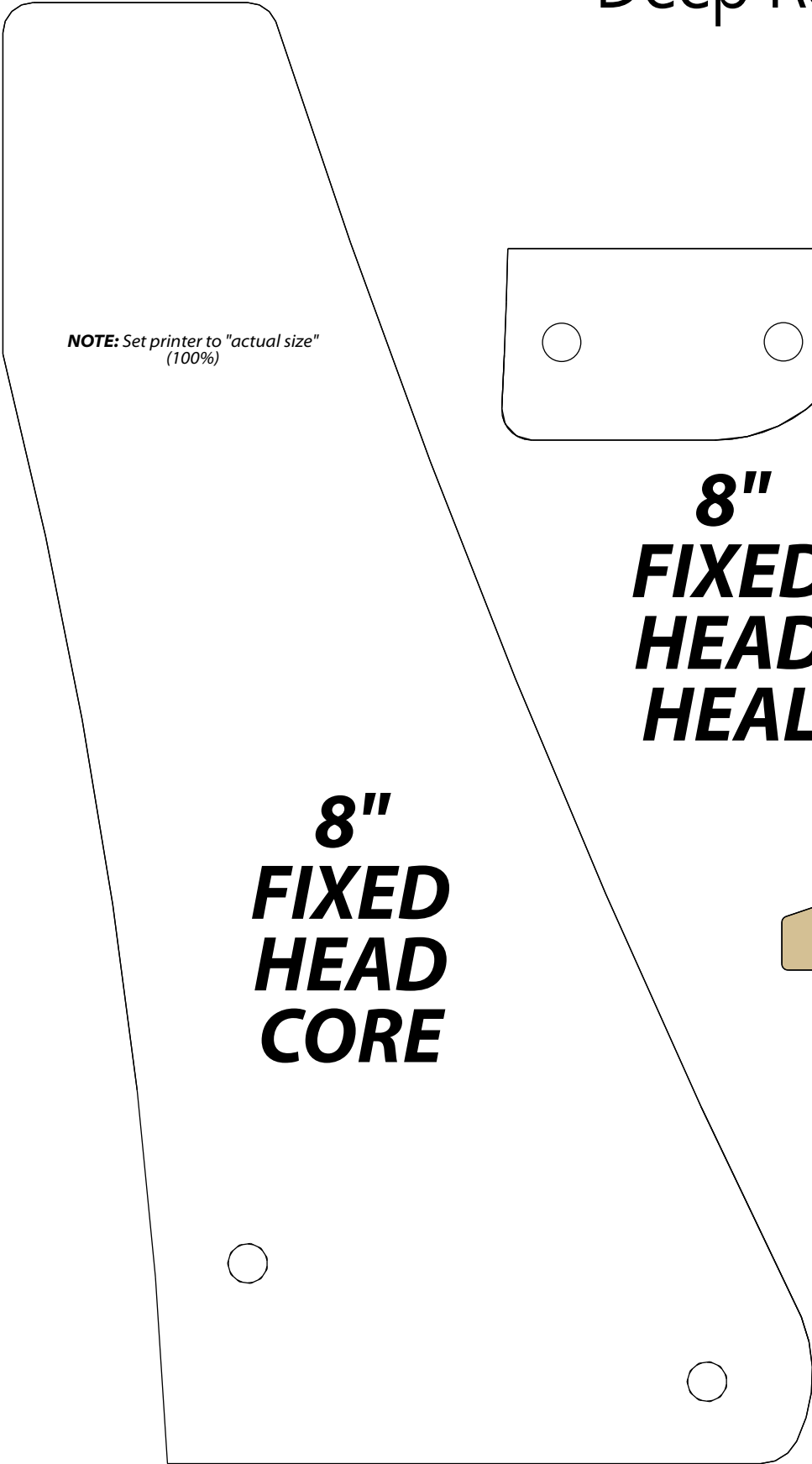

NOTE: Set printer to "actual size"
(100%)

**8"
FIXED
HEAD
CORE**

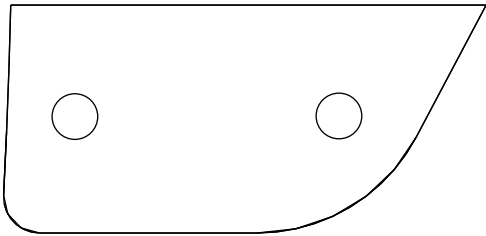

**8"
FIXED
HEAD
HEAL**

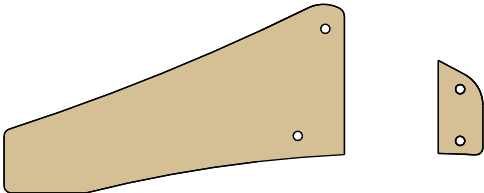

8 "FIXED HEAD

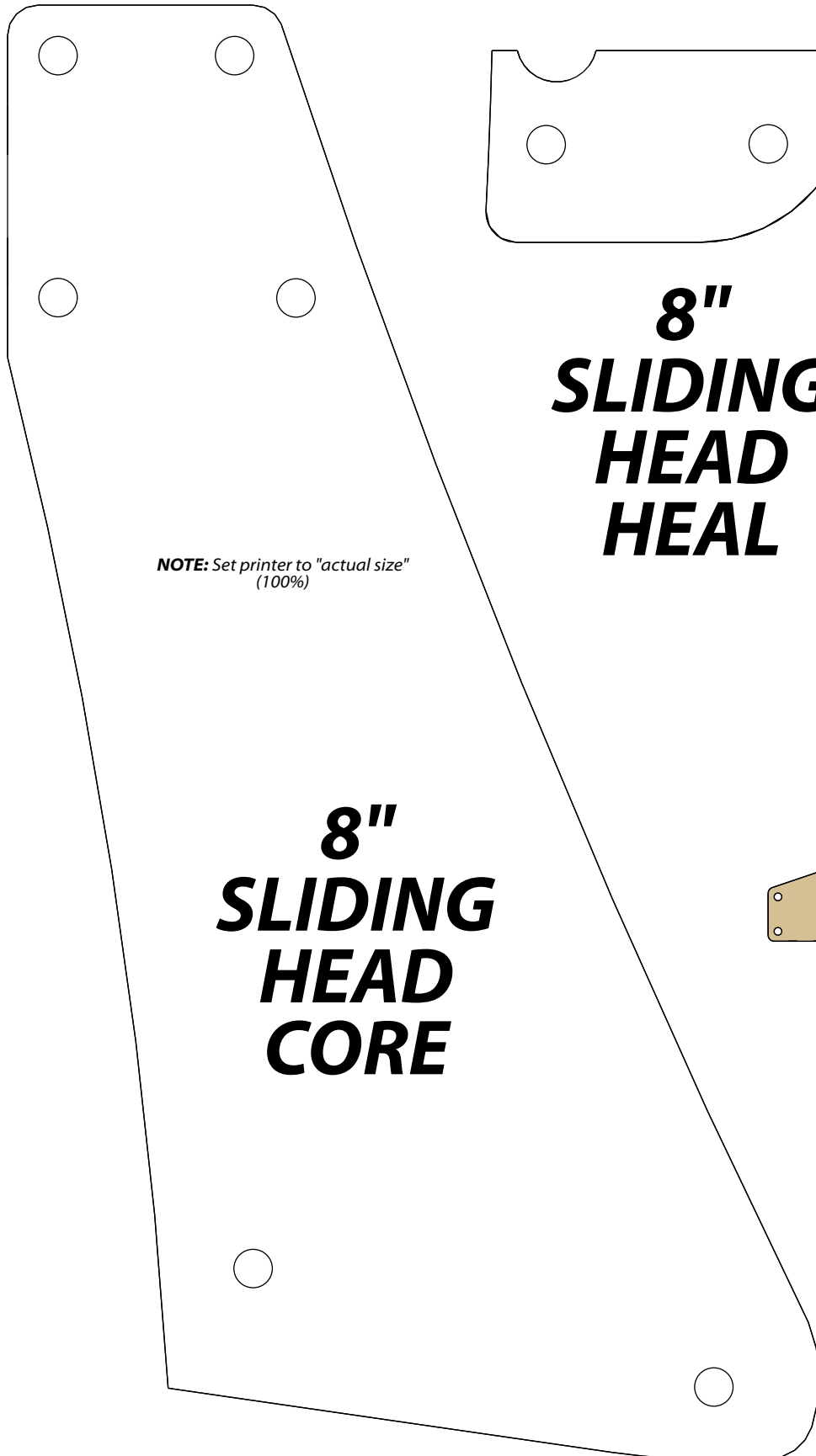

NOTE: Set printer to "actual size"
(100%)

**8"
SLIDING
HEAD
CORE**

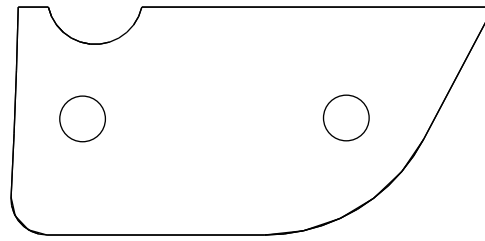

**8"
SLIDING
HEAD
HEAL**

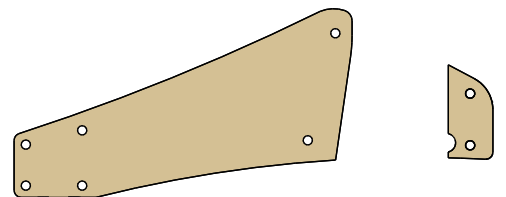

8" SLIDING HEAD

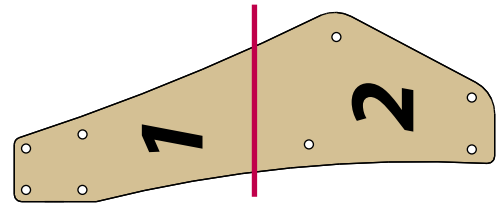

8" HEAD SIDE

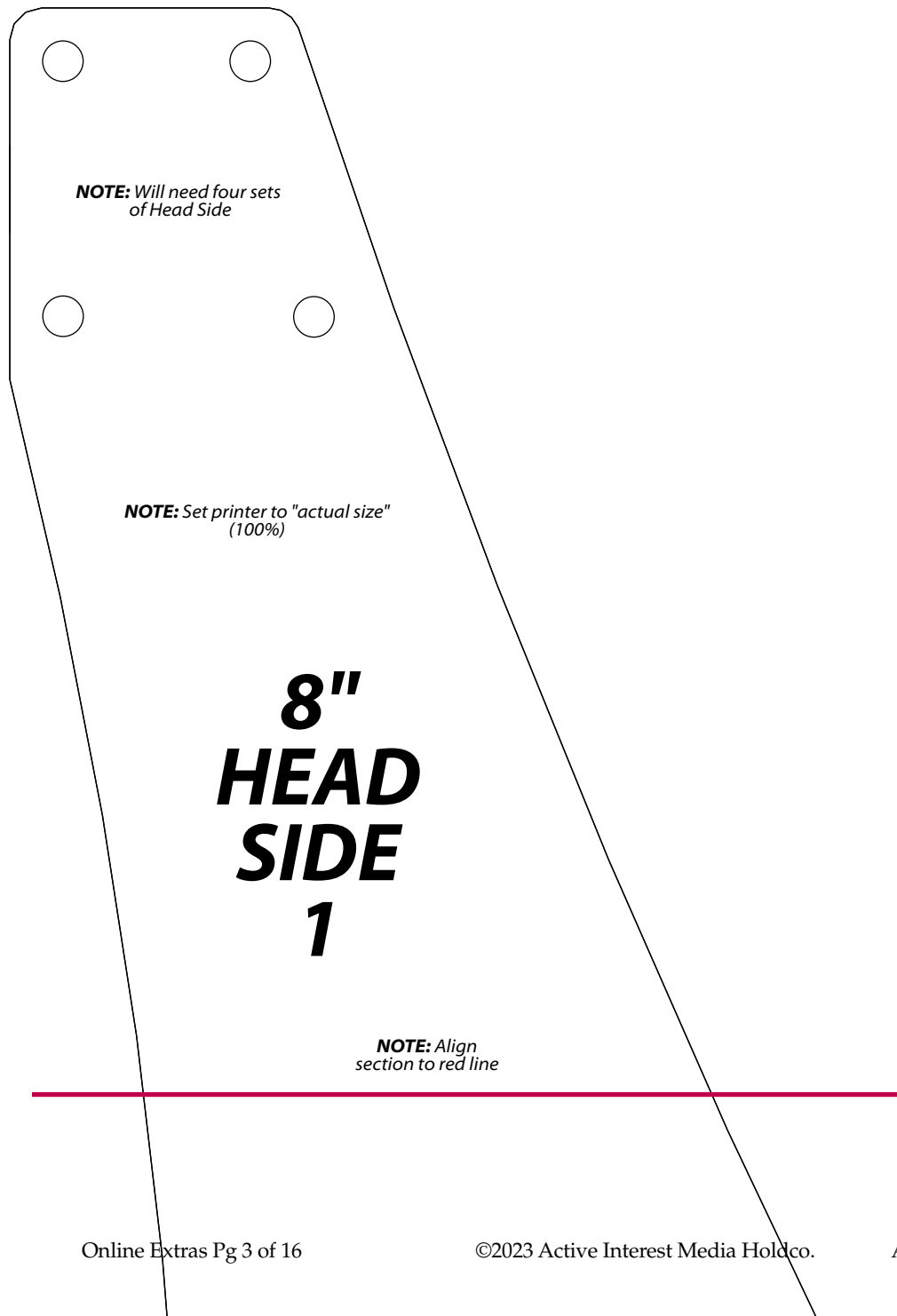

NOTE: Will need four sets
of Head Side

NOTE: Set printer to "actual size"
(100%)

**8"
HEAD
SIDE
1**

NOTE: Align
section to red line

NOTE: Align
section to red line

8"
HEAD
SIDE
2

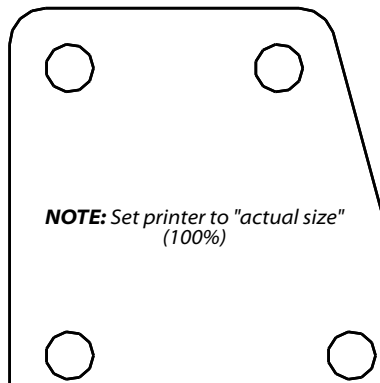

NOTE: Set printer to "actual size"
(100%)

**10"
FIXED
HEAD
CORE
1**

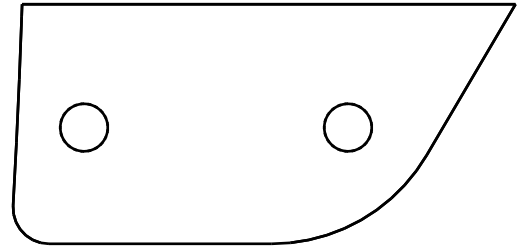

**10"
FIXED
HEAD
HEAL**

NOTE: Align
section to red line

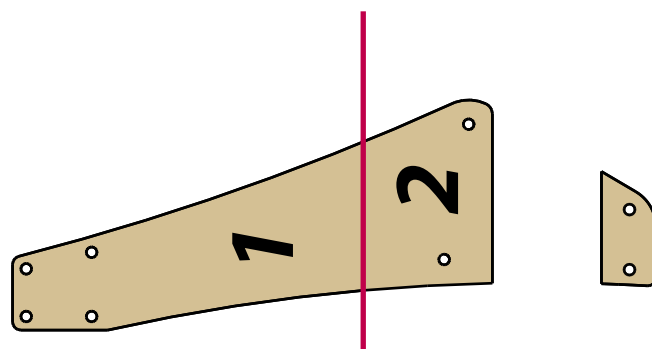
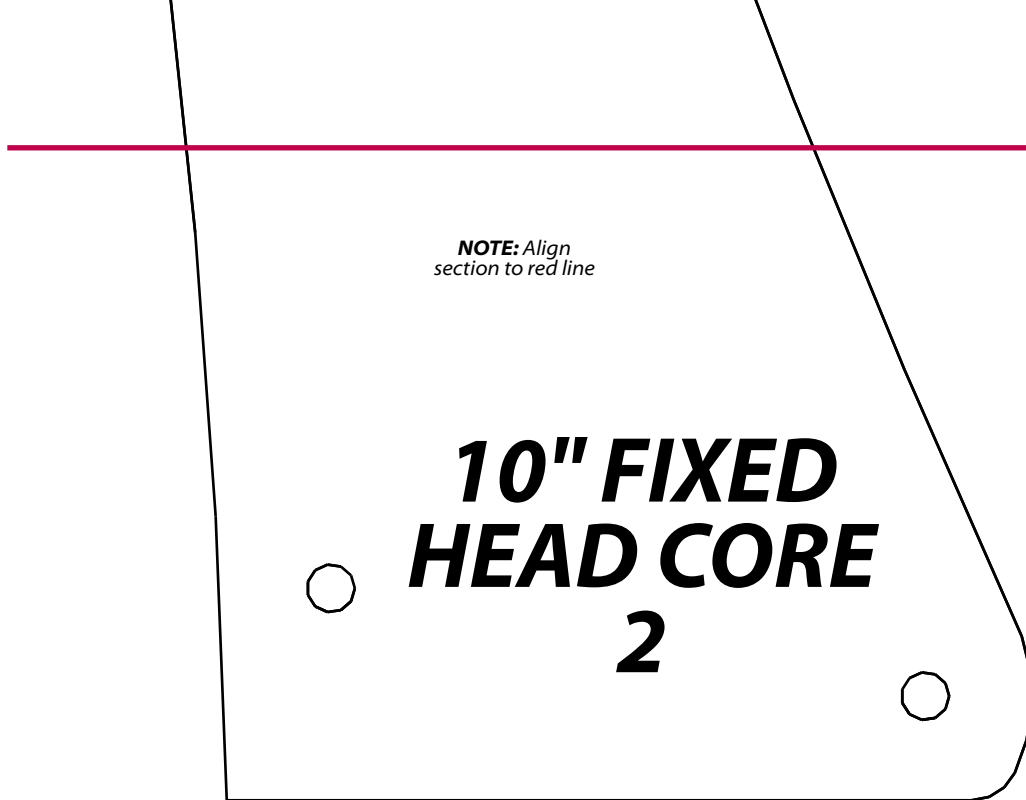

10" FIXED HEAD

NOTE: Set printer to "actual size"
(100%)

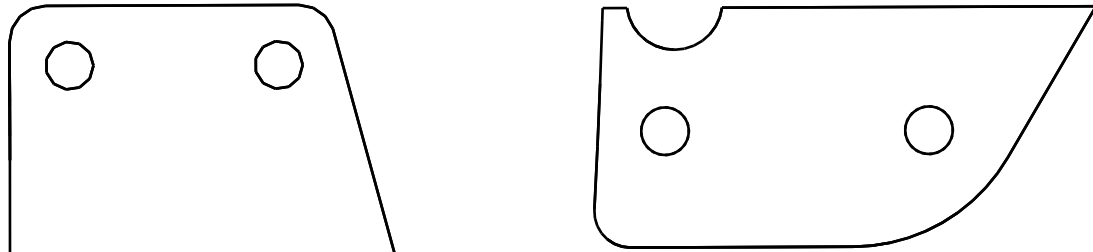

**10"
SLIDING
HEAD
HEAD**

**10"
SLIDING
HEAD
CORE
1**

NOTE: Align
section to red line



NOTE: Align
section to red line

**10"
SLIDING
HEAD CORE
2**

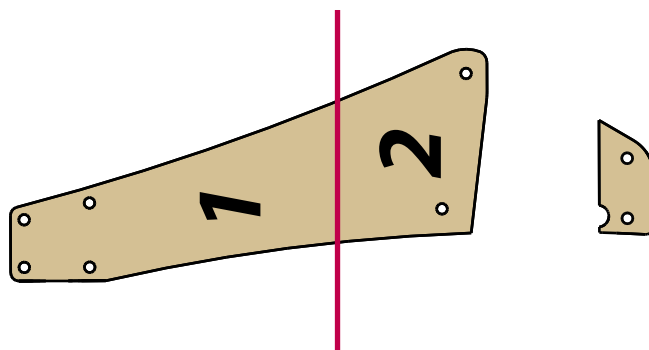

10" SLIDING HEAD

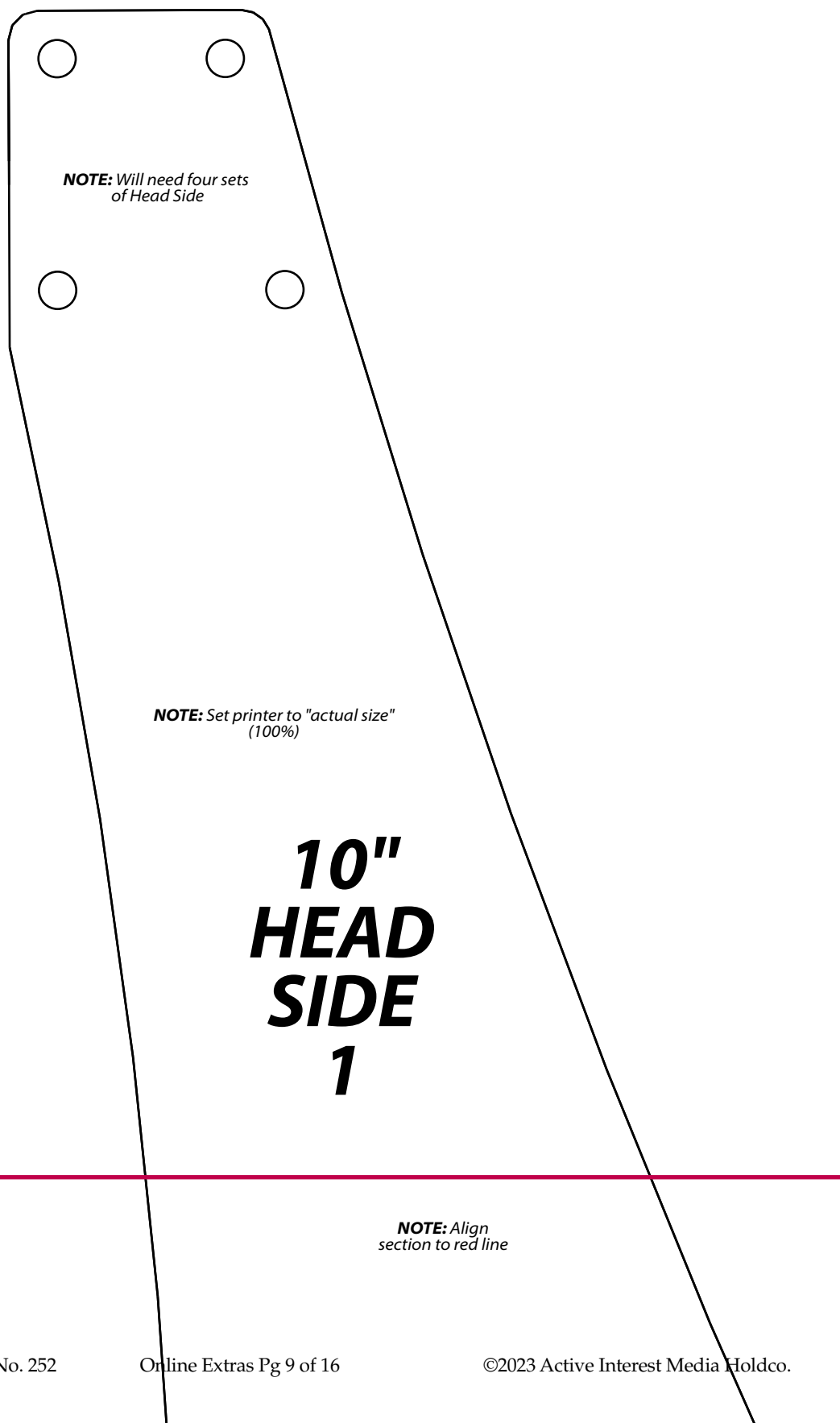

NOTE: Will need four sets
of Head Side

NOTE: Set printer to "actual size"
(100%)

**10"
HEAD
SIDE
1**

NOTE: Align
section to red line

NOTE: Align
section to red line

**10"
HEAD
SIDE
2**

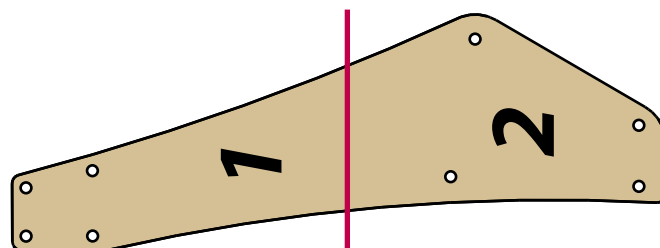

10" HEAD SIDE

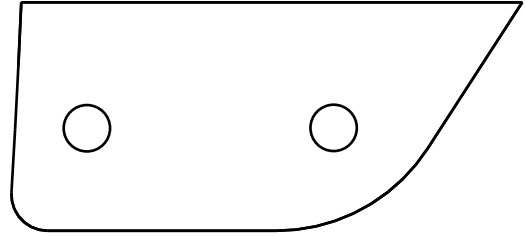

**12"
FIXED
HEAD
HEAL**

**12"
FIXED
HEAD
HEAL
1**

NOTE: Align
section to red line



NOTE: Align
section to red line

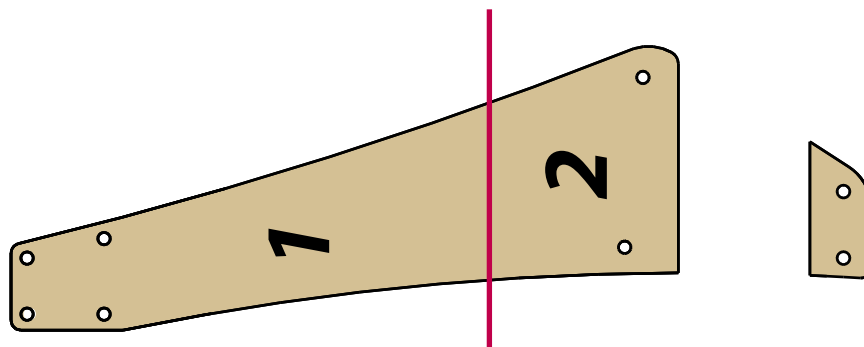
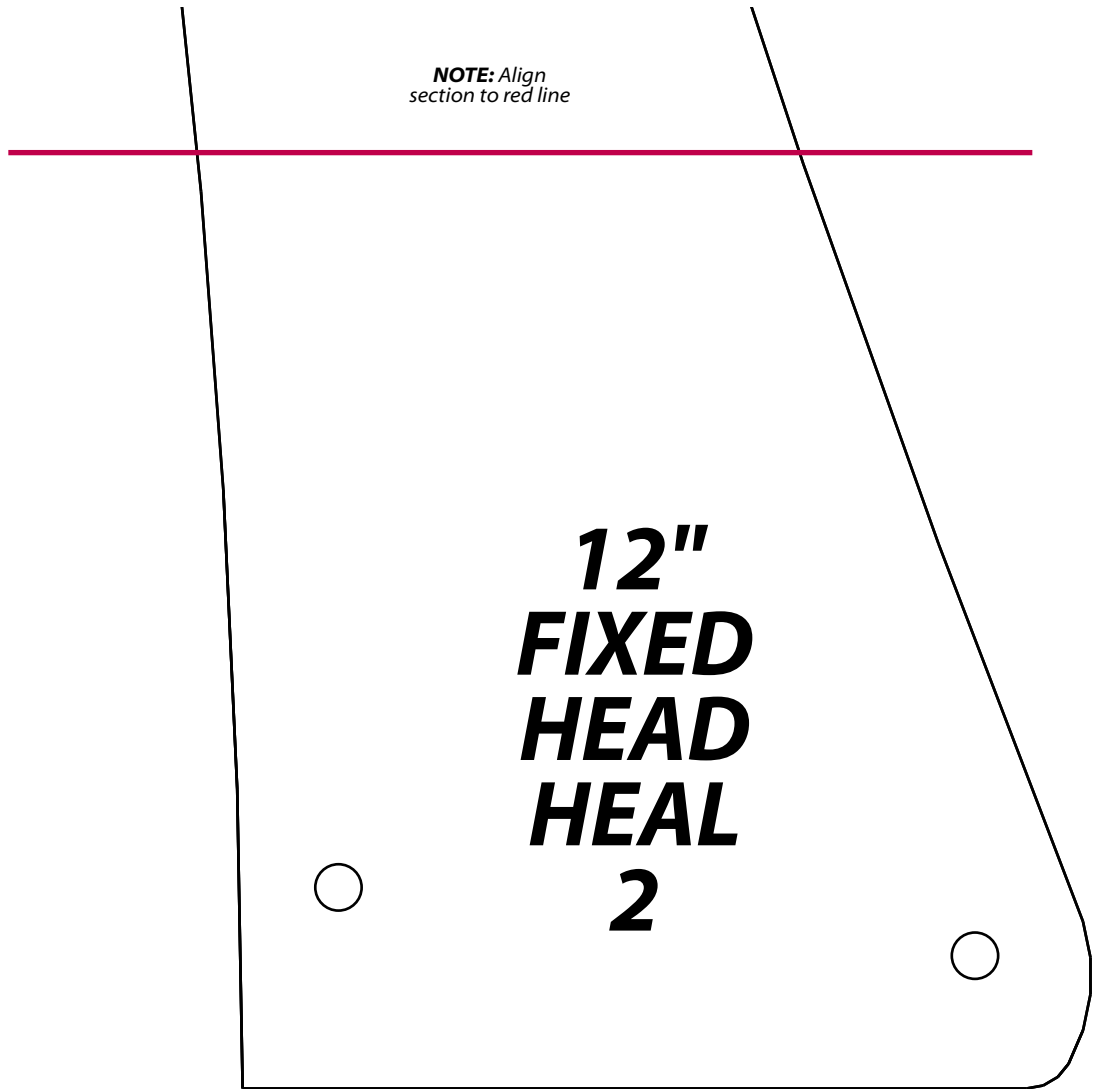

12" FIXED HEAD

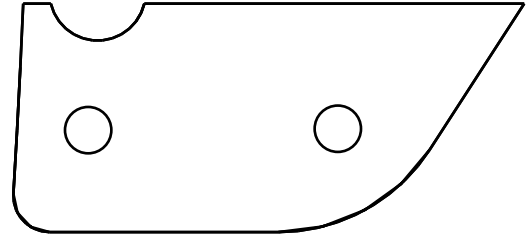

**12"
SLIDING
HEAD
HEAD**

**12"
SLIDING
HEAD
CORE
1**

NOTE: Align
section to red line

NOTE: Align
section to red line

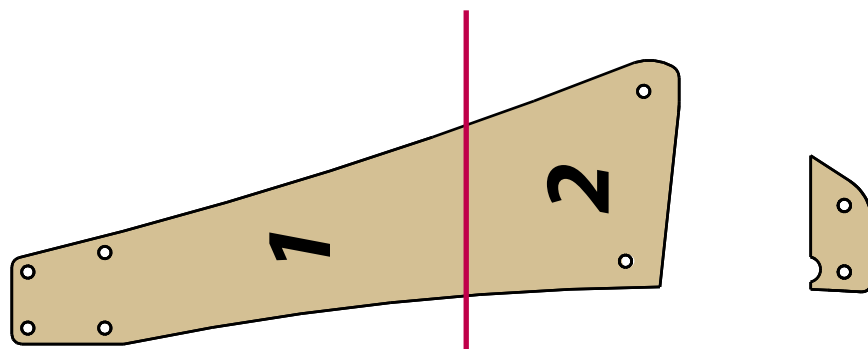
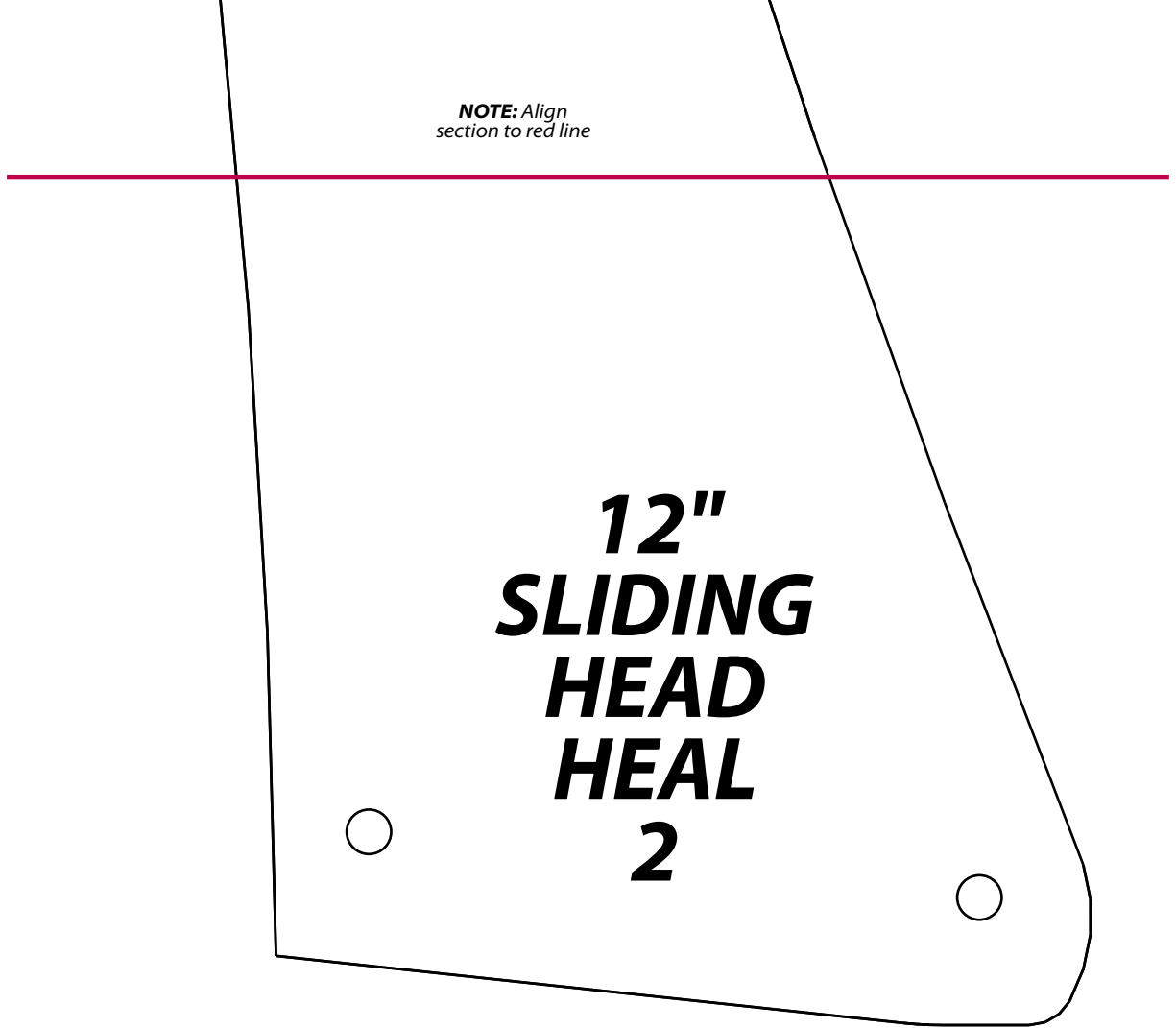

12" SLIDING HEAD

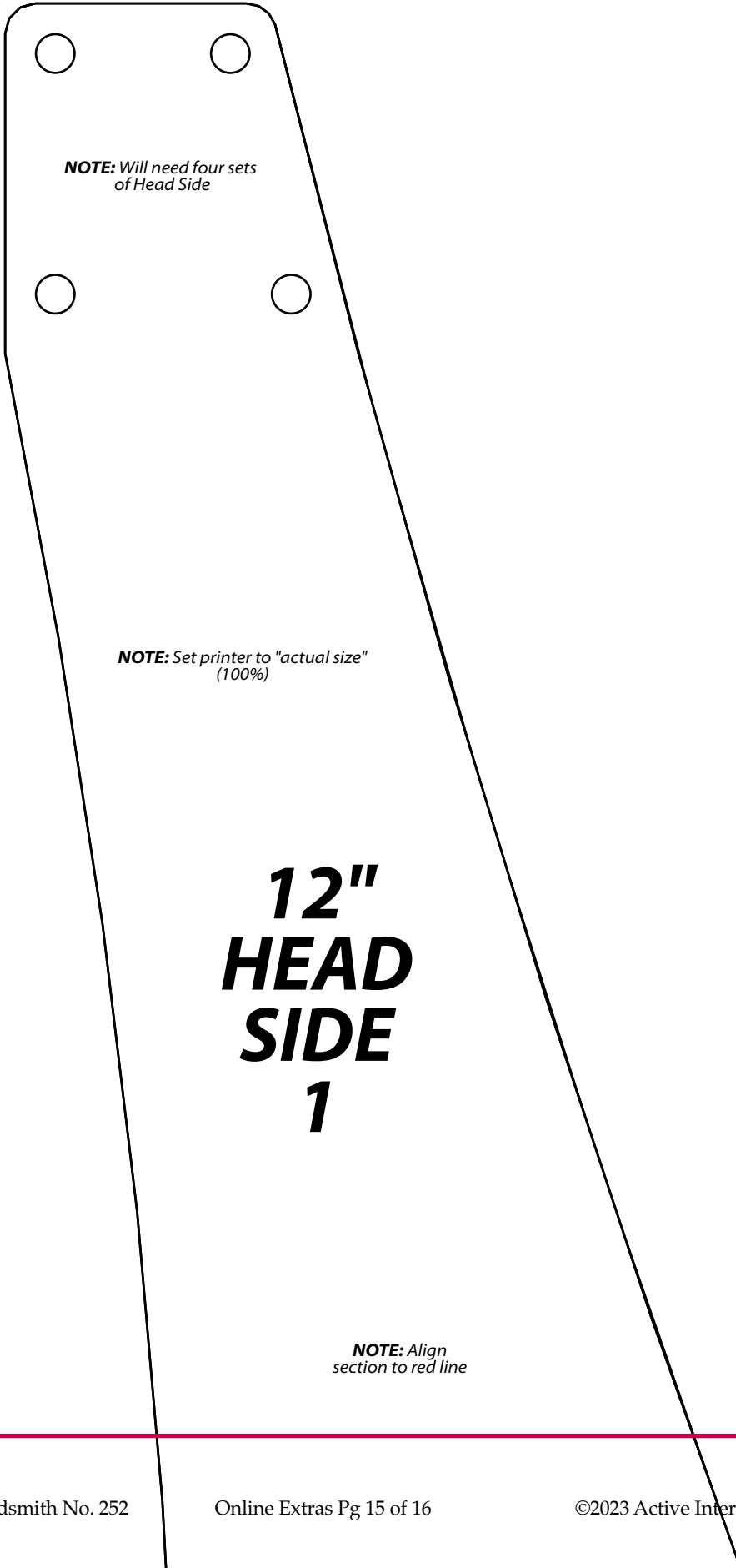

NOTE: Will need four sets
of Head Side

NOTE: Set printer to "actual size"
(100%)

**12"
HEAD
SIDE
1**

NOTE: Align
section to red line

NOTE: Align
section to red line

**12"
HEAD
SIDE
2**

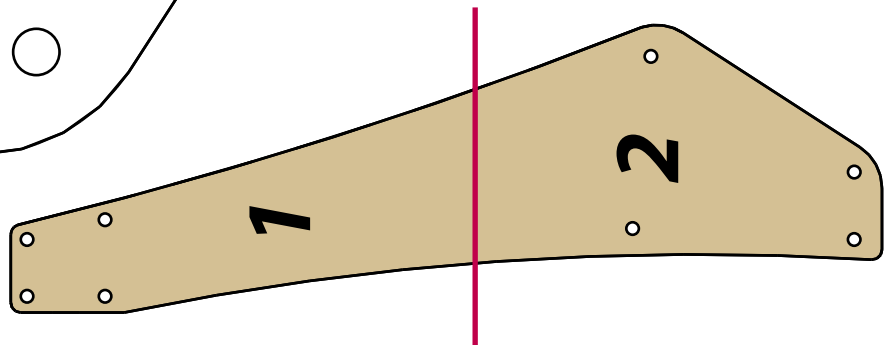

12" HEAD SIDE